

# SOUTHBURY LAND TRUST Bassett Preserve

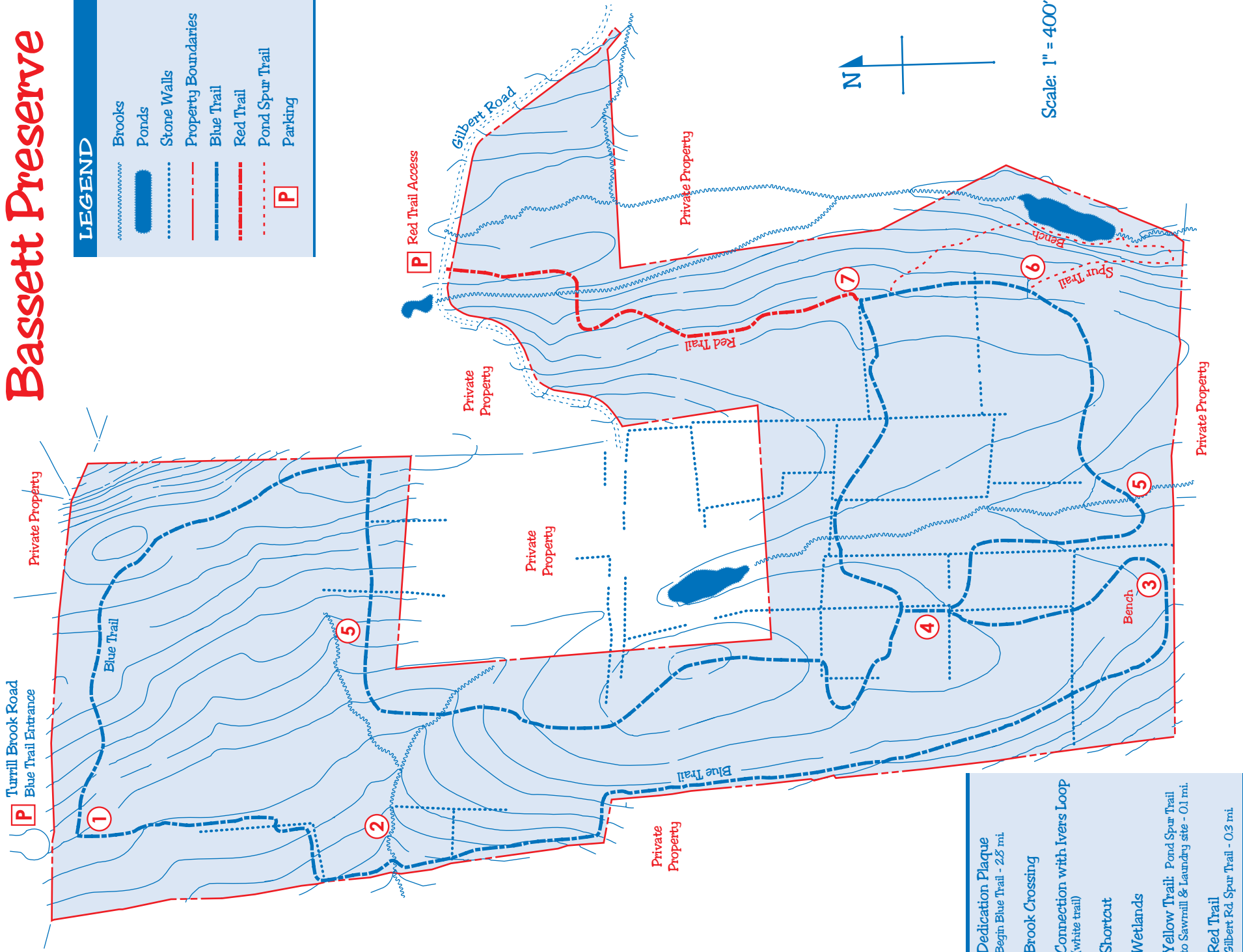

## LEGEND

- Brooks
- Ponds
- Stone Walls
- Property Boundaries
- Blue Trail
- Red Trail
- Pond Spur Trail
- Parking

- 1. Dedication Plaque**  
Begin Blue Trail - 2.8 mi.
- 2. Brook Crossing**
- 3. Connection with Ivers Loop**  
(white trail)
- 4. Shortcut**
- 5. Wetlands**
- 6. Yellow Trail: Pond Spur Trail**  
to Sawmill & Laundry site - 0.1 mi.
- 7. Red Trail**  
Gilbert Rd. Spur Trail - 0.3 mi.

Scale: 1" = 400'

# Bassett Preserve

Donated by the Bassett Family in the 1980's, Paradise Hill Preserve encompasses 112.8 acres of lovely New England countryside.

The Preserve, 600 feet above sea level in some spots, is comprised of rolling hills, deciduous forest, ridgeline and wetlands. The western trail portions provide easy hiking through oak forest, while the east is rugged with exposed ledge and boulders. The low-lying areas are densely vegetated with trees, shrubs and ground cover. Mountain Laurel abounds and brooks and streams flow throughout the property. Crisscrossing every quadrant are the numerous stonewalls, reminders of over 200 years of agricultural use that alternated between logging, grazing and food crops. Today these same stonewalls provide shelter to hibernating salamanders and snakes, offer cover for chipmunks and other small animals, as well as direct watercourses. The southeast portion of the trail also passes the foundation ruins of a sawmill and commercial laundry operated by the Gilbert Family who owned the land from 1752 until 1940.

Please enjoy Paradise Hill Preserve's trails, flora, fauna, geology, history, peace, quiet and trail map—the first in the series of Southbury Land Trust Nature Preserve Trail Maps.

## Preserve Policy

- *This nature preserve is open from sunrise to sunset for the enjoyment of Southbury Land Trust members, town residents and their guests.*
- *Please stay on the designated trails and do not trespass on private property.*
- *In order to maintain the natural qualities of this area, please avoid disturbing plants and wildlife.*
- *No dumping, littering, smoking, fires, swimming, hunting, trapping or motorized vehicles are allowed.*
- *Help keep this preserve clean – Leave only footprints. Take only pictures.*

*Thank you.*

*Southbury Land Trust, Inc. June 2004*

## If you go...

Paradise Hill (#28 on the Southbury Land Trust Parcel Map) is located in the Purchase section of Southbury and accessed via Route 172, Spruce Brook Road, Purchase Brook Road, Brown Brook Road to the main entrance (Blue Trail - 2.8 miles) on Turrill Brook Road where there is parking at end of the cul-de-sac. A second entrance (Red Trail - .3 miles) is located on Gilbert Road, with parking for a few cars.

## SOUTHBURY LAND TRUST

# Harry & Dorothy Bassett Preserve Trail Map

The Southbury Land Trust, founded in 1978, is a private non-profit conservation organization dedicated to the protection and preservation of Southbury's natural resources for the enjoyment and benefit of all present and future residents.

The Trust is supported solely by memberships and donations. All dues, contributions, bequests, memorials and gifts of stock are tax deductible.

The office is located at 68 1/2 Bennett Square. (Mailing address P.O. Box 600, Southbury, CT 06488). Please call (203)264-4441 for office hours or with questions regarding membership, land donations, contributions or volunteering.



Funding for this map and membership mailing provided by  
The Newtown Savings Bank and  
United Way of Greater Waterbury